



the perfect venue for your conference,  
exhibition and meeting needs

[www.brightoncentre.co.uk/conference](http://www.brightoncentre.co.uk/conference)

# Where Brighton & the World meet

Combining a seaside location with a vibrant city atmosphere, Brighton is one of England's most accessible and compact cities for national and international events. Nestling between the South Downs and the sea, the city's Regency squares and crescents provide a golden backdrop to the restaurants and bars, pubs and cafes, and dozens of clubs and live music venues which make Brighton such a great place to relax as well as do business.

Top attractions to enjoy whilst in Brighton include the world famous Royal Pavilion, summer palace of King George IV, Brighton Marina with its boardwalk of bars and restaurants, all enjoying spectacular sea views, and the exciting Brighton Pier, one of England's top free tourist attractions.

With five shopping districts including the famous and historic Lanes and North Laine, over 400 restaurants and the sparkling nightlife, the only commodity in short supply will be time.

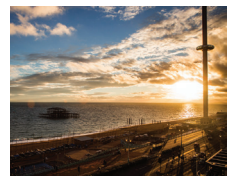

## AT A GLANCE



**Brighton Centre is one of the largest purpose built conference and exhibition centres in the South of England.**

**With an events team experienced in managing high security and high profile events alongside the flexible and compact nature of the building, Brighton Centre continues to be the popular choice for conferences, exhibitions and meeting organisers.**

**Complimented on our light, airy and spacious interiors, with panoramic sea views and easy access, the Brighton Centre offers clients a professional venue with the capacity to accommodate up to 4,450 delegates.**

**Our informative sales staff and experienced managers are ready to convert your enquiry into a successful event.**

**Let our vibrant city, flexible venue and experienced staff welcome your delegates.**

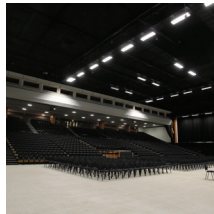

	theatre style	exhibition	banquet	cabaret	reception	boardroom	classroom
<b>ground floor</b>							
<b>Meeting Room 1</b> room can be split to create a further two, three or four additional rooms	350	460sq m	288	192	-	-	100
<b>Foyer</b>	-	1,300sq m	-	-	800	-	-
<b>first floor</b>							
<b>Auditorium 1</b>	4,450	1,941sq m	1,000	800	2,500	-	800
<b>Auditorium 2</b>	600	597sq m	350	280	800	-	200
<b>Office 2</b>	-	-	30	24	-	20	-
<b>second floor</b>							
<b>Meeting Room 3</b>	50	-	50	40	-	20	20
<b>Office 3</b>	-	-	-	-	-	2	2
<b>Office 4</b>	-	-	10	8	-	4	-
<b>Meeting Room 5</b>	50	-	50	40	-	30	30
<b>third floor</b>							
<b>Skyline</b>	300	320sq m	192	128	400	-	150
<b>Meeting Room 6</b>	50	-	60	48	-	30	30
<b>Office 7</b>	-	-	-	-	-	4	-
<b>Meeting Room 8</b>	50	-	60	48	-	20	20
<b>Meeting Room 9</b>	70	-	60	48	-	30	30
<b>Meeting Room 10</b>	60	-	50	40	-	30	30
<b>Office 11</b>	40	-	40	32	-	20	20
<b>Office 13</b>	20	-	20	16	-	12	12
<b>Mass Media</b>	80	-	80	96	120	40	40
<b>The Wing</b>							
<b>Syndicate 1 &amp; 2</b>	400	391sq m	240	160	400	-	130
<b>Syndicate 3 &amp; 4</b> each floor can be split to give half capacities	400	400sq m	240	160	400	-	130
<b>Meeting Room 14</b>	30	-	30	24	-	12	12
<b>fourth floor</b>							
<b>Meeting Room 15</b>	80	-	60	48	-	30	40

## GROUND FLOOR



### Foyer

The Brighton Centre's Foyer is an impressive, light and spacious entrance. With one entire wall of glass entrance doors and marble flooring, even the busiest registration demands can be met with ease and style.

The open-plan design enables event organisers to choose their own layout for maximising impact as their guests arrive. For large exhibitions using the Brighton Centre, it adds a valuable 1,300m<sup>2</sup> of additional space to the venue.

### Meeting Room 1

Meeting Room 1 is located to the back of the foyer and can be used as additional exhibition space or as a breakout facility. The room can be divided into sections with soundproof walling, giving a further two, three or four rooms. If the entrance foyer is being used for exhibition space it acts as an extension to the foyer giving a total of 1,760m<sup>2</sup> space on the ground floor.

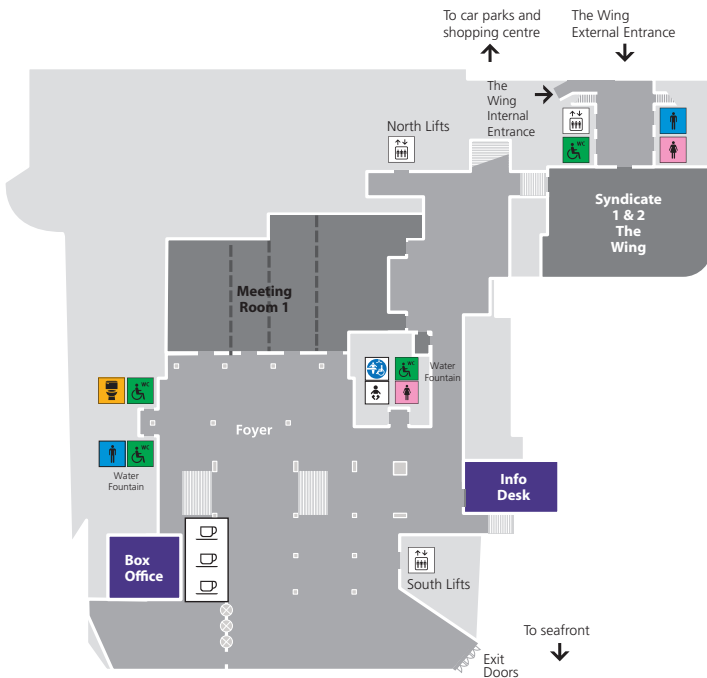
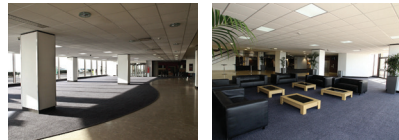

## Capacity

## Meeting Room 1

Theatre	350
Classroom	100
Banquet	288
Cabaret	192
Exhibitions	460sq m / 4,951sq ft

NB: Meeting Room 1 may be sub-divided into two, three or four sections with a soundproof partition, creating up to four rooms ranging from 60-100 theatre style

## Foyer

1,300sq m / 13,993sq ft approx

## Dimensions

## Meeting Room 1

Length	34.3m / 112' 6"
Width	10.9m / 35' 9" minimum 18m / 59' maximum
Height	2.8m / 9' 2" minimum 3m / 9' 10" maximum
Loading	floor 488kg/m <sup>2</sup> / 100lb/ft <sup>2</sup>
Exhibitions	460sq m / 4,951sq ft

(due to shape of room minimum dimensions are given)

## Foyer

Min ceiling height	2.33m / 7' 7"
Max ceiling height	3.14m / 10' 4"
Loading	
- carpet floor	488kg/m <sup>2</sup> /100lb/ft <sup>2</sup>
- marble floor	244kg/m <sup>2</sup> /50lb/ft <sup>2</sup>

## Lighting

## Meeting Room 1

LED lighting  
Total blackout capability  
Additional spotlighting facilities available

## Access

## Meeting Room 1

Height	2.39m / 7' 10"
Maximum access via Auditorium 1 chair lift (subject to availability)	
Width	2.68m / 8' 6"
Height	2.21m / 7' 3"
Door from foyer	
Height	2.1m / 6' 10"
Width	1.75m / 5' 8"

## Foyer

(front exit doors for load in)

Height	2.3m / 7' 6"
Width	2.1m / 6' 10"

## Power

## Meeting Room 1

32A TP+N 415v (240v SP+N)  
30A TP+N 415v (240v SP+N)  
32A SP+N  
13A socket outlets around the perimeter of the room

## Foyer

60A TP+N 415v (240v SP+N)  
13A socket outlets around the perimeter  
30A SP+N 240v

## Features

## Meeting Room 1

Air conditioning  
Water & waste facilities

## Foyer

Secure area for storage  
Information desk with experienced staff  
Box Office facilities  
Baby changing area  
Both areas serviced by central tannoy system  
Mobile cloakroom facilities for up to 1,000  
Accessible toilets  
Wireless internet access

## FIRST FLOOR



### Auditorium 1

The Brighton Centre's Auditorium 1 is the setting for major political and international conferences, prestige exhibitions, grand banquets and product launches. It is valued by corporate event organisers and production companies needing a very large adaptable space to create branded sets within.

With a flat floor area of just under 2,000m<sup>2</sup>, exhibition organisers can benefit from a large uninterrupted space. For conferences, the seating can be laid out in any configuration and with the use of the three balconies, the maximum seating capacity reaches an impressive 4,450.

Auditorium 1 is flanked on either side by the spacious East and West bars and landings. There is plenty of additional space for fast refreshment breaks, networking areas or additional exhibition stands.



To car parks and shopping centre

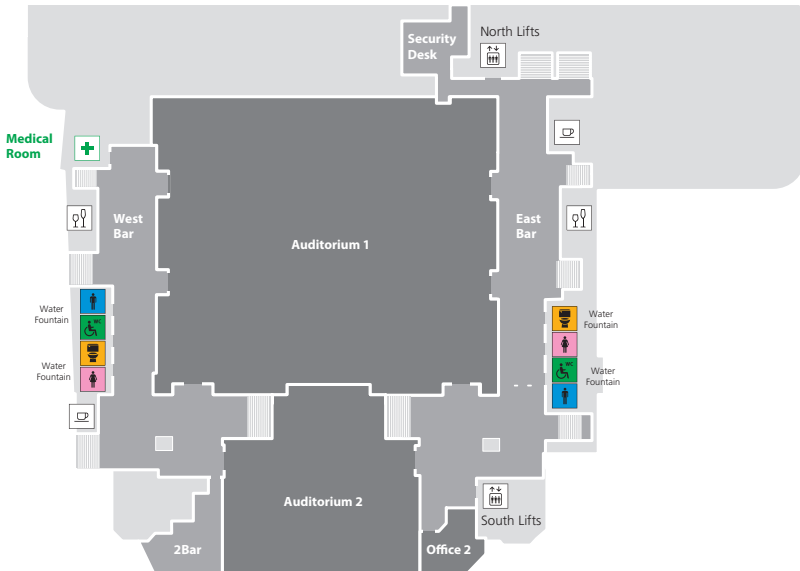

**Capacity**

**Auditorium 1**

Theatre	4,450
Classroom	800
Banquet	1,000
Cabaret	800
Standing Reception	2,500
Exhibitions	1,941sq m / 20,893sq ft

**Dimensions**

Length	47.7m / 156' 6"
Width	40.7m / 133' 6"
Height	15m / 49' floor to ceiling 12.12m / 39' 9" floor to underside of catwalk
Loading	floor 1,220kg/m <sup>2</sup> / 250lb/ft <sup>2</sup> staging 488kg/m <sup>2</sup> / 100lb/ft <sup>2</sup>

**Lighting**

**Total blackout capability**  
**Fluorescent house lights**  
 - (dimmer controlled) average level of illumination 500lux  
**Spot, Flood and Fresnel lighting available**

**Equipment**

- 278.7sq m / 3,000sq ft of Merrick Sico multi-height stage units
  - Mobile retractable Bleacher seating system, up to 920 seats
  - Fixed retractable Bleacher seating system
  - Portable seating for up to 2,000
  - Crowd control barriers
  - Accessible viewing platform
  - Tables 6ft dia and 2ft 6" dia
  - Fork lift (2,000 kg - 4,408lb)
- A full range of the latest conference technology can be made available via local suppliers

**Access**

**Direct loading access** width 22.8m / 74' 10"  
 height 5.2m / 17' 1"  
 depth 13m / 42' 8"

**Height of raised loading deck** 1.04m / 3' 5"

**Loading bay doors** width 6m / 19' 8" - height 3.8m / 12' 5"

**Ramp to stage doors (right)** width 3.4m / 11' 2"

**Stage doors right (two pairs)** width 1.4m - height 1.8m

**Parking for 5 x 40ft trucks or equivalent**

**Ample public access points**

**Wheelchair access**

**Power**

**200 TP+N 415v (240v SP+N)** - busbars on east, south and west sides

**60A TP+N 415v (240v SP+N)** - take off points

**4000A TP+N 415v (240v SP+N)**

**100A TP+N 415v (240v SP+N)**

**13A socket outlets around the perimeter of auditorium**

Additional power available on request

**Sound**

**House PA system includes**

- 10 Flare Audio X5s
- Mixing desk
- Microphones
- Tie lines
- Central tannoy system

Demonstrations available on request

**Features**

**Air conditioning**

**Water & waste facilities**

**Flying points**

**8 booths for simultaneous translation**

**Induction loop**

**Wireless internet access**

## FIRST FLOOR



### Auditorium 2

Auditorium 2 offers an excellent versatile meeting space. With a bank of windows down the length of one wall, delegates can enjoy uninterrupted views of the beachfront. Blackout facilities however, are also available. As the seating in Auditorium 2 is not fixed, the room can be laid out to the organisers' individual requirements.

Using the link room between Auditorium 1 and Auditorium 2, exhibition organisers can benefit from an additional 597m<sup>2</sup> of continuous floor space.

At either end of Auditorium 2 are smaller meeting spaces: Office 2 and 2Bar, which can work well as organisers' offices, speakers' rooms or for syndicate sessions.

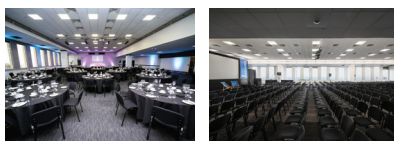

To car parks and shopping centre

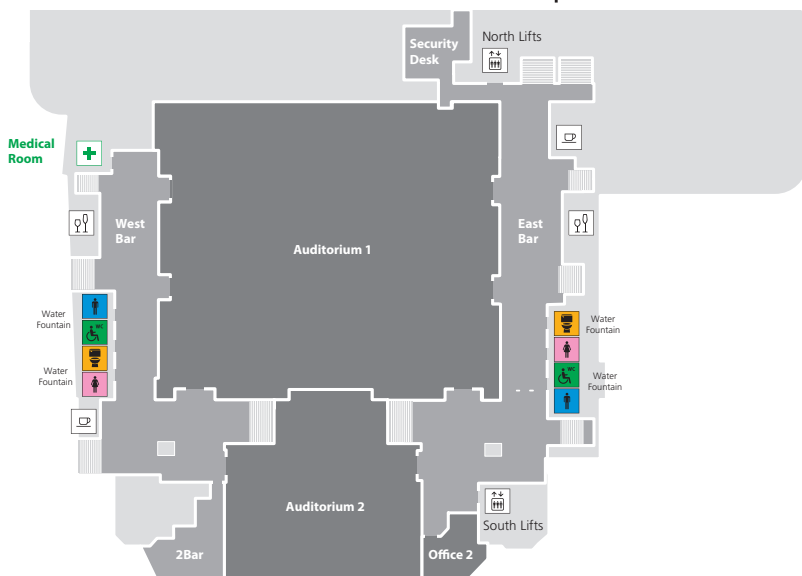

**Capacity**

**Auditorium 2**

Theatre	600
Classroom	200
Banquet	350
Cabaret	280
Standing reception	800
Exhibitions	597sq m / 6,426sq ft

**Office 2**

Banquet	30
Cabaret	24
Boardroom	20

**Dimensions**

**Auditorium 2**

Length	(E-W) 29.7m / 97' 5"
Width	(N-S) 20.17m / 66' 2"
Height	2.99m / 9' 10" minimum 4.38m / 14' 5" maximum
Loading	floor 488kg/m <sup>2</sup> / 100lb/ft <sup>2</sup> staging 488kg/m <sup>2</sup> / 100lb/ft <sup>2</sup>

**Office 2**

Length	9m
Width	4m
Height	3.79m

**Lighting**

**Auditorium 2**

- Total blackout capability
- LED lighting
- Additional spotlights available

**Equipment**

**Auditorium 2**

- 8' x 4' stage units - height 1' or 2'
- Stock of Tables and Chairs
- A full range of the latest conference technology can be made available via local suppliers

**Access**

**Auditorium 2**

- Link room doors (dependent upon access through Auditorium 1) width 11.8m / 38' 8" - height 2.2m / 7' 2"
- Alternative doors width 1.6m / 5' 2" - height 2.0m / 6' 6"
- Ample public access points
- Wheelchair access

**Power**

**Auditorium 2**

- 60A TP+N 415v (240v SP+N)
- 13A socket outlets around the perimeter of auditorium

**Sound**

**Auditorium 2**

- House PA system includes
  - soundtrack: 16 x 2 x 1
  - Central tannoy system

**Features**

**Auditorium 2**

- Air conditioning
- Bar en suite
- Adjacent room / office with en suite washroom facilities, suitable for organisers office (Office 2)
- High level room suitable for projection (west end of hall) and for sound mixing
- Induction loop

## SECOND FLOOR



### Meeting Rooms & Offices: 3-5

A suite of two main meeting rooms and an office with natural daylight, along with a small dressing room and shower room make up the second floor. The suite is located conveniently close to Auditorium 1 and has the infrastructure / supporting technology for clients to use as the centre for their organisers' operations.

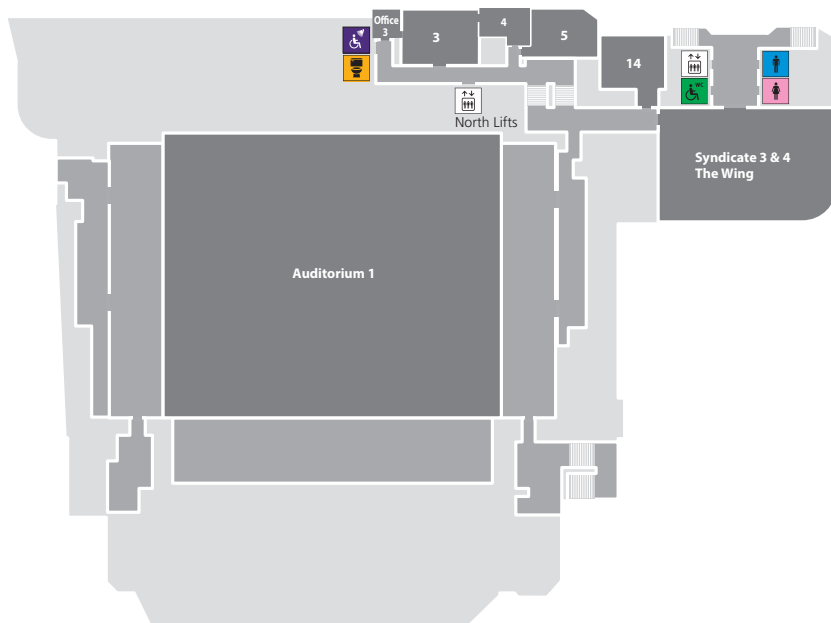

**Capacity**

**Meeting Room 3**

Theatre	50
Banquet	50
Cabaret	40
Boardroom	20

**Office 3**

Boardroom	2-4
-----------	-----

**Office 4 - Office plus en suite shower**

**Meeting Room 5**

Theatre	50
Banquet	50
Cabaret	40
Boardroom	30

**Dimensions**

**Meeting Room 3**

Length	8m
Width	7m
Height	2.20m

**Office 3**

Length	5.60m
Width	2.30m minimum 3.50m maximum
Height	2.30m

**Office 4**

Length	4m
Width	3.5m
Height	2.20m

**Meeting Room 5**

Length	9.40m
Width	7m
Height	2.24m

**Lighting**

**All Rooms**

A full range of intimate and high level lighting options  
A degree of blackout available

**Equipment**

**Meeting Room 3**

Digital screen and sound system

**Office 4**

Office plus en suite shower

**Meeting Room 5**

Digital screen and sound system

**All Rooms**

Stock of tables, chairs and lounge furnishings

**Access**

**All Rooms**

Accessed by passenger lifts / stairs  
height 2.02m - width 0.71m (min) 1.55m (max)

**Power**

**All Rooms**

13A socket outlets around the perimeter of the room  
Larger supplies may be provided by arrangement

**Facilities**

**All Rooms**

Wireless internet access

## THIRD FLOOR



### Meeting Rooms & Offices: 6-13 • Meeting Room 15 Mass Media Area

An extensive range of smaller meeting rooms, offices, media and back stage catering areas make up the third floor back stage suite.

Meeting Room 15 is located on a mezzanine level, above the third floor suite.

Offering capacities from 12-80 the third floor suite, along with Meeting Room 15, is the ideal location for additional breakouts and parallel sessions.

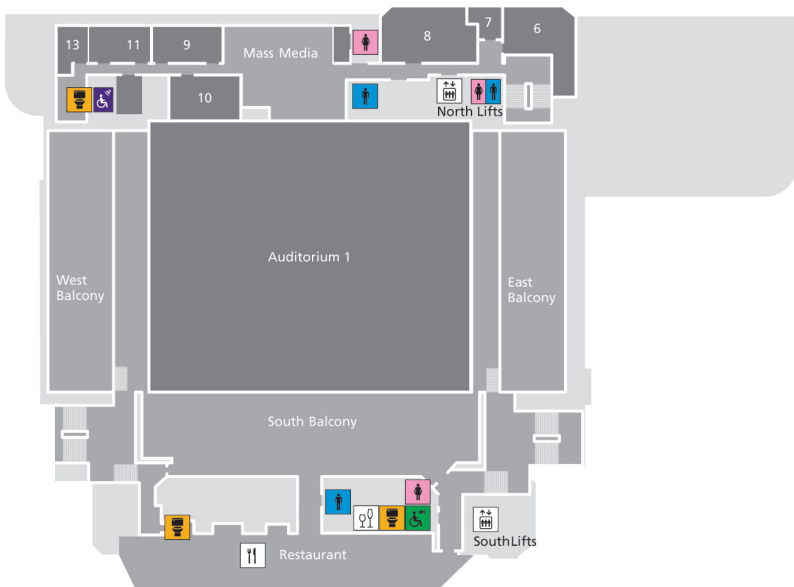

**Capacity**

**Meeting Room 6**

Theatre	50
Banquet	60
Boardroom	20

**Office 7** Office

**Meeting Room 8**

Theatre	50
Banquet	60
Boardroom	20

**Meeting Room 9**

Theatre	70
Banquet	60
Boardroom	30

**Meeting Room 10**

Theatre	60
Banquet	50
Boardroom	30

**Office 11**

Theatre	40
Banquet	40
Boardroom	20

**Office 13**

Theatre	20
Banquet	20
Boardroom	12

**Mass Media Area**

Theatre	80
Banquet	80
Boardroom	40
Press Area	120

**Meeting Room 15**

Theatre	80
Banquet	60
Boardroom	30
Classroom	40

**Dimensions**

**Meeting Room 6**

Length 10m - width 7m - height 2.3m

**Office 7**

Length 5.5m - width 2.5m - height 2.3m

**Meeting Room 8**

Length 8.2m - width 7.2m - height 2.3m

**Meeting Room 9**

Length 10.62m - width 5m - height 2.8m

**Meeting Room 10**

Length 9m - width 5.07m - height 4m

**Office 11**

Length 15m - width 5.2m height 2.68m

**Office 13**

Length 5m - width 3.79m - height 2.68m

**Mass Media Area**

Length 5.10m - width 13.67m - height 2.82m

**Meeting Room 15**

Length 12.5m - width 5.5m - height 2.2m

**Lighting**

A full range of intimate and high level options  
A degree of blackout available

**Equipment**

Digital screen in Meeting Room 6.  
Projector, screen and sound system - available in Meeting Rooms 8, 9, 10, 15, Office 11, Mass Media Area and Meeting Room 15.  
Screened annexe available in Meeting Room 6 and sink in Office 7  
Stock of tables, chairs and lounge furnishings available in all rooms

**Access**

Accessed by passenger lifts / stairs  
height 2.02m - width 0.71m (min) 1.55m (max)

**Power**

13A socket outlets around the perimeter of the room  
Larger supplies may be provided by arrangement

**Facilities**

Changing area with showers  
Wireless internet access

## THIRD FLOOR



### Skyline

The Skyline is a stunning, sea-facing space for up to 400 people offering unrivalled, panoramic sea views. Accessed directly from the Foyer, it's a light, spacious and versatile function room ideal for VIP/speakers' lunches, plus evening receptions and dinners.

During exhibitions at the Brighton Centre it works well as a hospitality / sponsors' suite and is a valuable breakout space for large conferences.

The Skyline offers breath taking views via its floor to ceiling windows and a beautiful glass walled outside terrace, allowing delegates to enjoy sea views and the sea air.

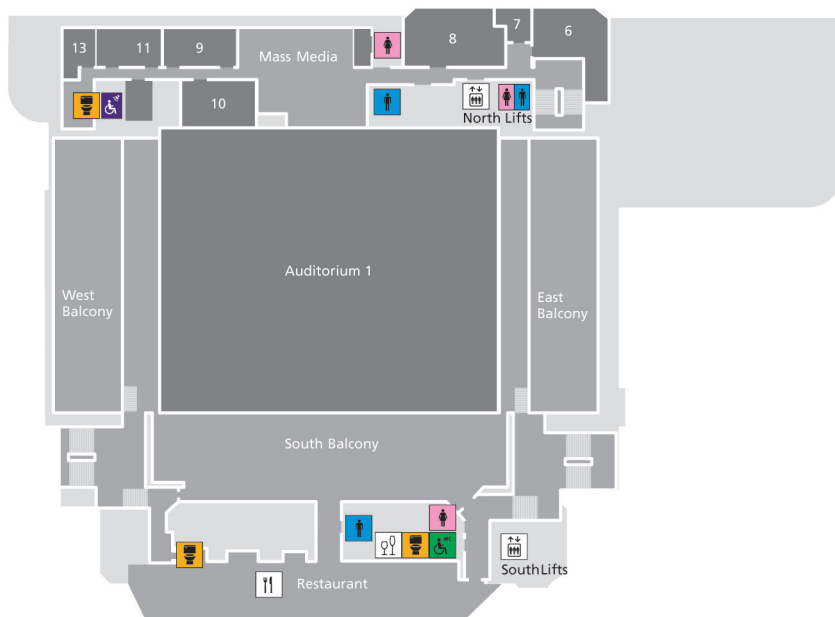

### Capacity

#### Skyline

Theatre	300
Classroom	150
Banquet	192
Cabaret	128
Standing Reception	400
Exhibitions	320sq m / 3,444 sq ft

### Dimensions

Floor Area	320sq m / 3,444sq ft
Between Pillars	
Length	30m / 98ft
Width	8.45m / 27ft
Height	2.95m / 9' 8" max - 2.35m / 7' 8" min

### Lighting

Blackout available  
LED panels  
Ample daylight  
LED coloured uplighters

### Equipment

Stock of tables, chairs and lounge furnishings  
En suite kitchen facilities

### Access

Accessed by passenger lifts / stairs  
height 1.98m - width 1.45m

### Power

13A socket outlets around the perimeter of the room  
Larger supplies may be provided by arrangement

### Facilities

Wireless internet access  
Air conditioning  
Bar area

- **5,000m<sup>2</sup> primary exhibition space**
- **4,450 plenary meeting capacity**
- **23 syndicate rooms**
- **Experienced operational team with the ability to run high security and prestigious international events**
- **Flexible approach to unique tailored events**
- **50 minutes by rail from central London**
- **30 minutes by rail from Gatwick International Airport**
- **Situated on the beachfront within 200 metres of major hotels and restaurants**
- **Centrally located in one of the UK's most vibrant and cultural cities**

## Ease of access for your delegates

- From airport arrivals to Brighton Centre registration desk in less than an hour
- 50 minutes by rail from London Victoria
- 30 minutes by rail or road from Gatwick International Airport
- 90 minutes by rail or road from London Heathrow
- Direct rail services from; Scotland, the North West, the Midlands, the West Country and South Wales
- M27 & M23 direct access to City
- Over 7,500 parking spaces in the centre of the City
- 10,000 bedrooms in 150 quality assured hotels all within 20 minute walk of the Brighton Conference Centre



[www.brightoncentre.co.uk/conference](http://www.brightoncentre.co.uk/conference)



Brighton Centre, King's Road, Brighton BN1 2GR

t. **01273 292671** e. **bcconference@brighton-hove.gov.uk**